

SAN - TRI-CLAMP THERMOWELL

SAN SERIES STYLE

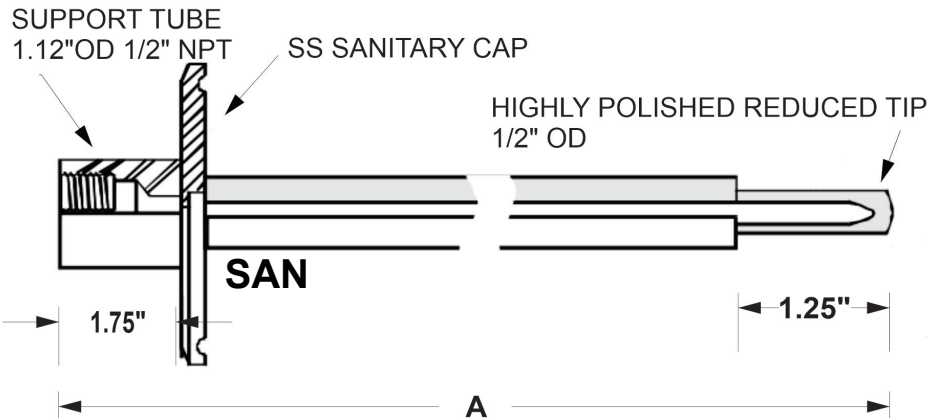
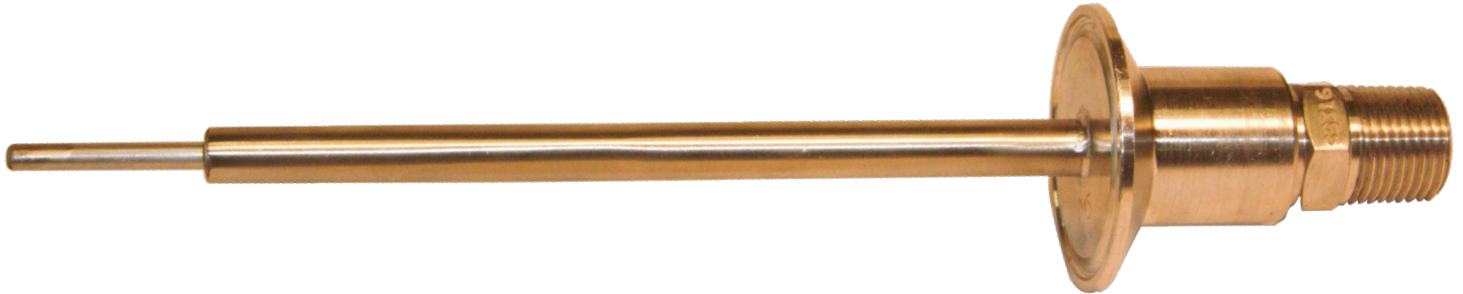

SANITARY TRI-CLAMP

Replacement thermowell for A4945, A4940

SAN-SERIES - ORDER CODE

SAN - A - X

STEM LENGTH	CAP SIZE
2 - 2" (50.8mm)	1.5 - 1.5" (38mm)
4 - 4" (101mm)	2 - 2" (51mm)
6 - 6" (152mm)	2.5 - 2.5" (63.5mm)
7.5 - 7.5" (190.5mm)	3 - 3" (76.2mm)
12 - 12" (304.8mm)	
15 - 15" (381mm)	
18 - 18" (457.2mm)	
X - CUSTOM	

CAP SIZES

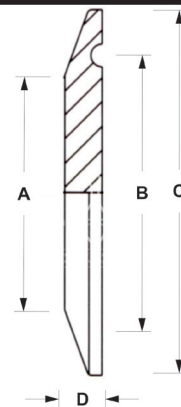

CAP SIZE ORDER CODE	A	B	C
1	1.22"	1.71"	1.99"
1.5	1.22"	1.71"	1.99"
2	1.75"	2.22"	2.52"
2.5	2.28"	2.78"	3.05"
3	2.82"	3.29"	3.58"
4	3.59"	4.33"	4.68"

T - DRILL THERMOWELL - THREAD CONNECTION

T-SERIES - THREADED STYLE

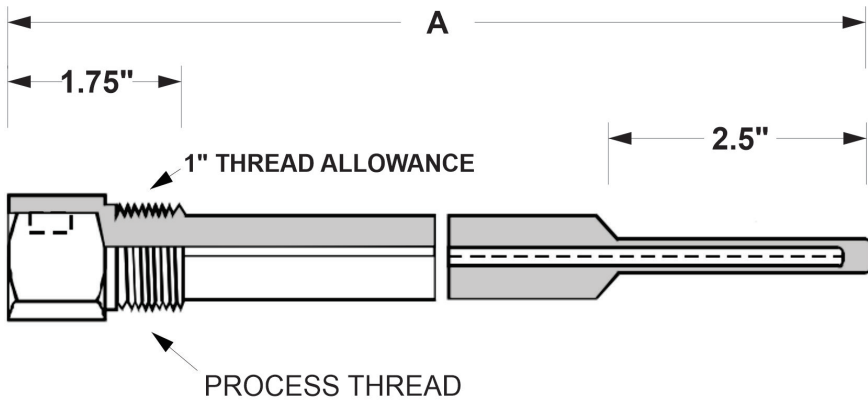
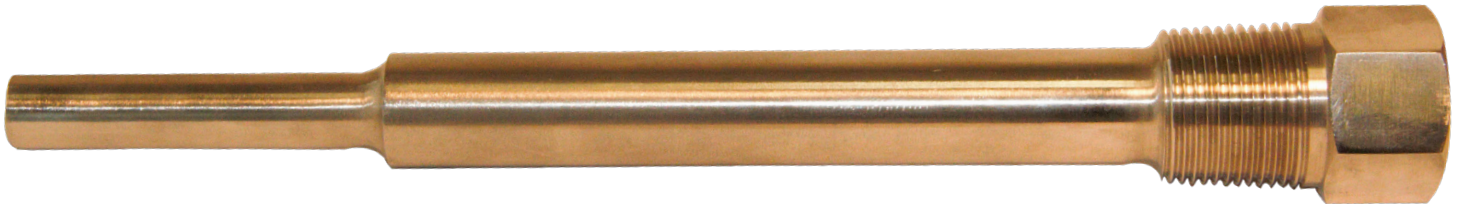

T SERIES THERMOWELL

Replacement thermowell for A4990, A4900

T-SERIES - ORDER CODE

TX - A - X - X

MATERIAL	STEM LENGTH	PROCESS CONNECTION	SENSOR CONNECTION
B - BRASS	2 - 2" (50.8mm)	1/2 - 1/2" NPT	1/2 - 1/2" NPT
S - 304SS	4 - 4" (101mm)	3/4 - 3/4" NPT	3/4 - 3/4" NPT
S6 - 316SS	6 - 6" (152mm)	1 - 1" NPT	1 - 1" NPT
X - CUSTOM	7.5 - 7.5" (190.5mm)	X - CUSTOM	X - CUSTOM
	12 - 12" (304.8mm)		
	15 - 15" (381mm)		
	18 - 18" (457.2mm)		
	X - CUSTOM		

PROCESS/ INSTRUMENT CONNECTION

MEASURE THE DIAMETER AT THE THICKER END OF THE TAPERED THREAD

NPT THREADS	
NPT THREAD SIZE	D DIMENSION
1/16"NPT	0.313"
1/8"NPT	0.405"
1/4"NPT	0.540"
3/8"NPT	0.675"
1/2"NPT	0.840"

TF - DRILLED THERMOWELL - FLANGED CONNECTION

TF-SERIES - FLANGED STYLE

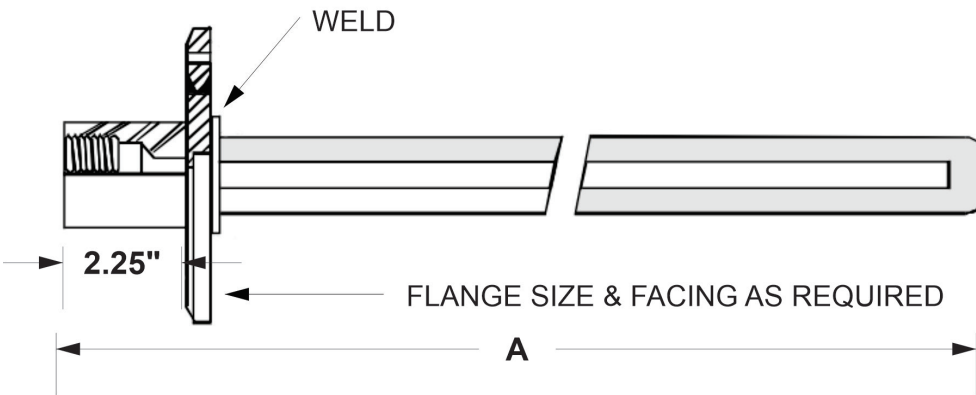
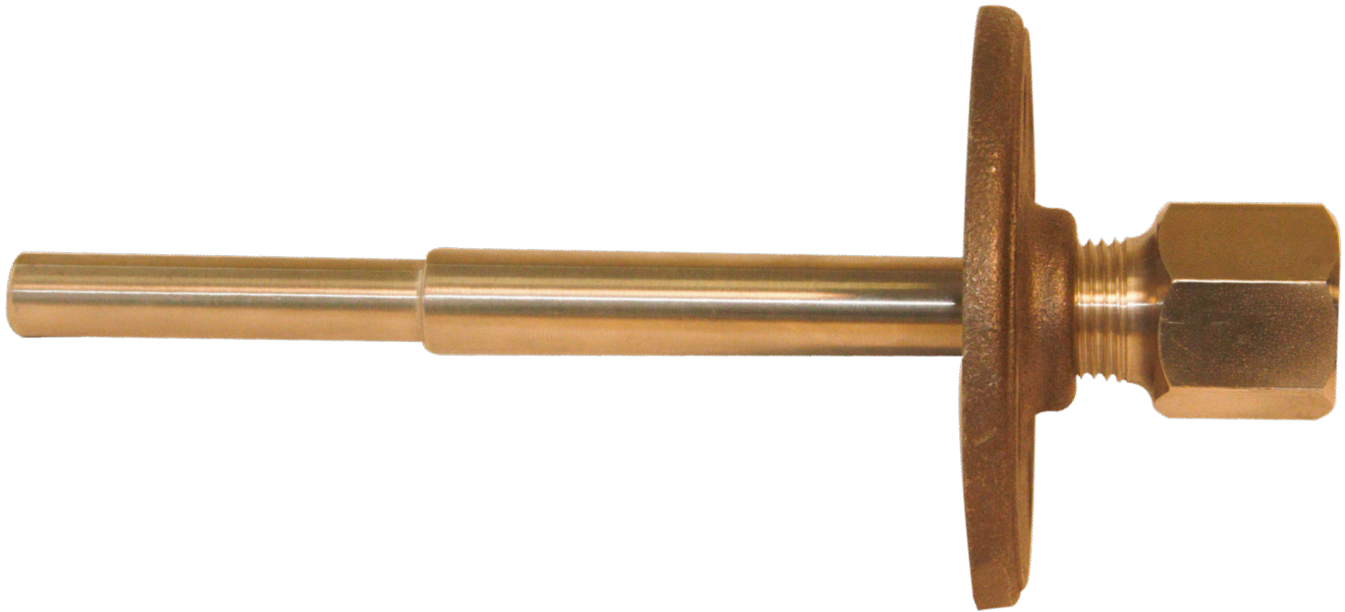

TF SERIES THERMOWELL

Replacement thermowell + flange for A4995

TF-SERIES - ORDER CODE

TFX - A - X - X - X

MATERIAL	STEM LENGTH	FLANGE	SENSOR CONNECTION	PRESSURE RATING
B - BRASS	2 - 2" (50.8mm)	1F - 1" FLANGE	1/2 - 1/2" NPT	150 - 150 PSI
S - 304SS	4 - 4" (101mm)	1.5F - 1.5" FLANGE	3/4 - 3/4" NPT	300 - 300PSI
S6 - 316SS	6 - 6" (152mm)	2F - 2" FLANGE	1 - 1" NPT	600 - 600PSI
X - CUSTOM	7.5 - 7.5" (190.5mm)		X - CUSTOM	
	12 - 12" (304.8mm)			
	15 - 15" (381mm)			
	18 - 18" (457.2mm)			
	X - CUSTOM			

FLANGE DIMENSIONS

