

FLANGED IMMERSION HEATERS

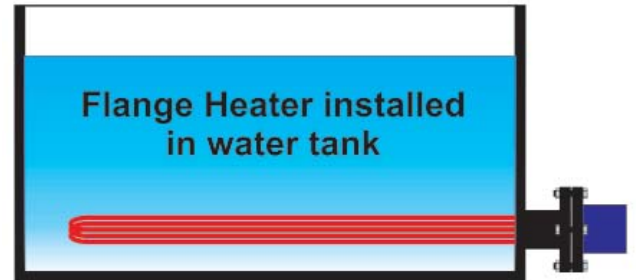

FEATURES

- 150 lb. ASA carbon steel flanges from 3" to 14" sizes .430" diameter copper, steel, 321 stainless steel, or Incoloy 800 elements
- 45, 22, 15, 13 and 6.5 watts/square inch for various processes
- General purpose, moisture or explosion resistant terminal enclosures
- Thermowell for 3/8" diameter thermostat bulb
- Bends are repressed after forming to recompact MgO and extend element life
- Instruction Manual with wiring instructions included with each unit

APPLICATIONS

- Copper Sheath:** Clean water, freeze protection, hot water storage, boiler and water heaters, cooling towers, heating of solutions not corrosive to copper
- Steel Sheath:** Asphalt, wax, paraffin, tar, fluid heat transfer medium, petroleum, degreasing and sol-vent, oils, fuel oils, machine oils, alcohol
- Stainless Steel Sheath:** Process water, soap and detergent solutions, soluble cutting oils, demineralized or delonized water (passivation recommended)
- Incoloy Sheath:** Solution water, corrosive solutions, air, gas, steam super heating

150# FLANGE DIMENSIONS

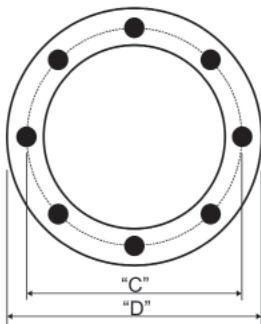

150# Flange Size	FLANGE OD	FLANGE Thickness	# HOLES	HOLE DIA	COLD (standard)	# ELEMENTS (standard / max)
3"-150#	7.5"	0.94"	4	3/4"	4"	3(standard) 6(max)
4"-150#	9"	0.94"	8	3/4"	4"	6(standard) 6(max)
5"-150#	10"	0.94"	8	7/8"	4"	6(standard) 9(max)
6"-150#	11"	1"	8	7/8"	4"	12(standard) 15(max)
8"-150#	13.5"	1.125"	8	7/8"	6"	18(standard) 24(max)
10"-150#	16"	1.187"	12	1"	6"	27(standard) 36(max)
12"-150#	19"	1.25"	12	1"	6"	36(standard) 54(max)
14"-150#	21"	1.375"	12	1.125"	6"	45(standard) 72(max)

*****Ask for more detailed PDF product brochure*****

MICA STRIP HEATER - Custom Specification Sheet

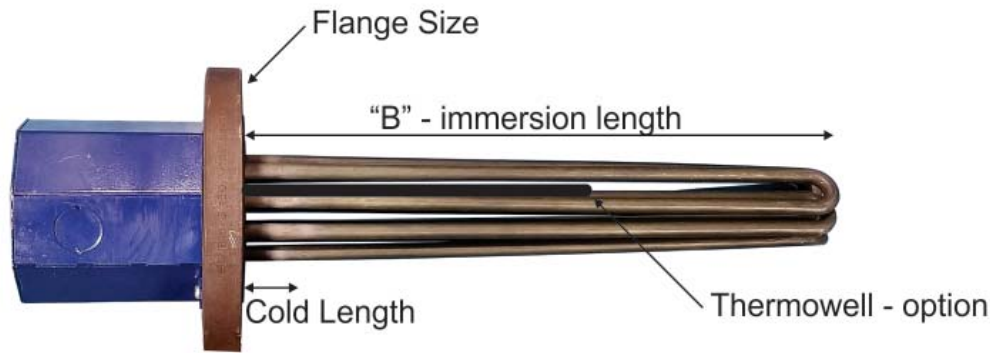

Company _____ City _____

Contact _____ Phone _____ Email _____

Max Operating Temp _____ F _____ C

WIDTH _____ in _____ mm **LENGTH** _____ in _____ mm **Watt** _____ **Volts** _____ **1PH/3PH** _____

Qty _____ Date Required : 1day 1week 2week

CONSTRUCTION:

CS CH (need DWG) CB (need DWG) CL (need DWG) CU (need DWG)

STEEL BACKPLATE:

1/8"Thick 3/16"Thick 1/4"Thick

ELECTRICAL TERMINATION

Post Terminals SN1 SN2 SN3 SN4 Ceramic Caps

Leadwire SL1 SL4 SB1 SB4 SC4

TGGT (482°F/250°C) MGT(900°F/450°C) LENGTH _____
 S/S Overbraid S/S Armour LENGTH _____ LOCATION _____

Terminal Box TB2(2 Terminal) TB3(3 Terminal) LOCATION(need DWG)

Euro Plug EP(standard) EPB(in BOX) LOCATION(need DWG)

HOLES (need sketch)