

BAYONET ADAPTERS - NORTH AMERICAN STANDARD + INSTALATION

BAYONET ADAPTERS - NA STANDARD

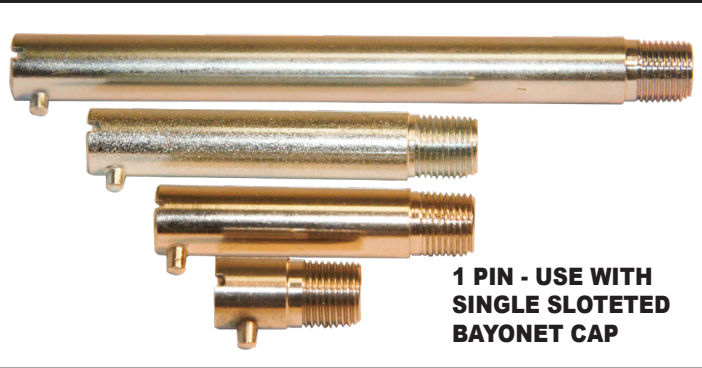

BAYONET ADAPTERS

Bayonet Adapters are used in conjunction with bayonet cap thermocouples (A500, A510, A100, A145, A190). The sensor tip is inserted into the bayonet adapter, the spring is compressed, and then the bayonet cap is locked into place ensuring a tight fit between the sensing junction and the measuring surface. This increases the sensor accuracy and response time.

BAYONET ADAPTERS - INSTALATION

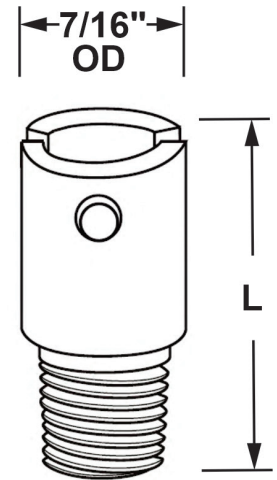
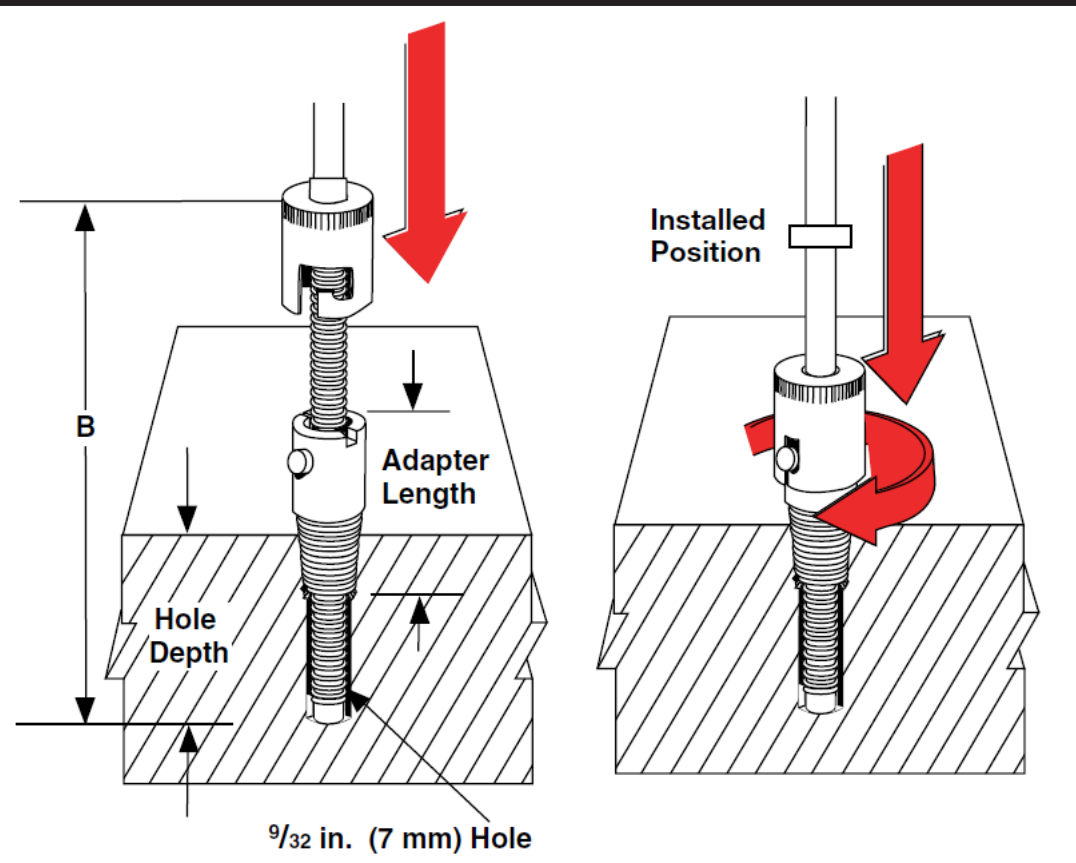

BAYONET ADAPTER - ORDER CODE

BA - L X

LENGTH	THREAD
1 - 7/8"	1 - 1/8"-27 NPT
2 - 1 1/2"	2 - 3/8"-24 NF
3 - 2 1/2"	
4 - 3 1/2"	

METRIC & PIPE CLAMP BAYONET ADAPTERS

METRIC BAYONET ADAPTERS - M12

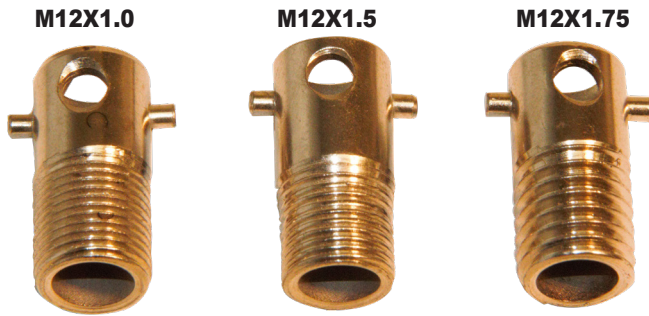

2 PIN - USE WITH DOUBLE SLOTTED METRIC BAYONET CAP

METRIC ADAPTER - ORDER CODE

BA - TxP

THREAD x PITCH

- M12x1.0 - M12 THREAD/ 1.0mmPITCH
- M12x1.5 - M12 THREAD/ 1.5mmPITCH
- M12x1.75 - M12 THREAD/ 1.75mmPITCH
- M14x1.5 - M14 THREAD/ 1.5mmPITCH
- M17x1.4 - M17 THREAD/ 1.4mmPITCH

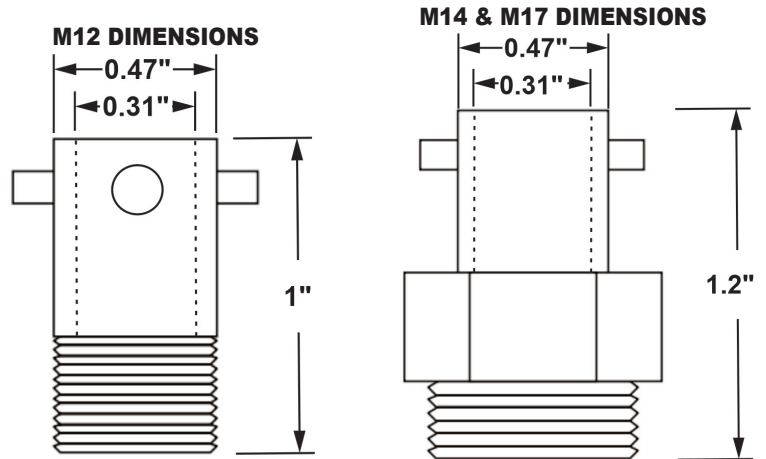

PIPE CLAMP BAYONET ADAPTER

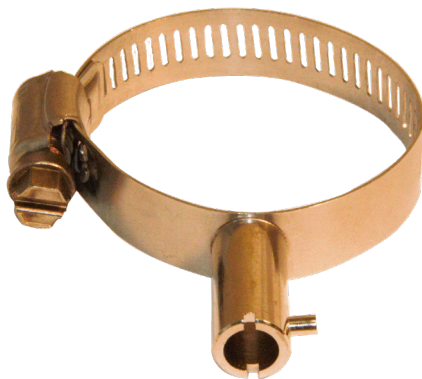

PIPE CLAMP BAYONET ADAPTERS

Pipe Clamp Bayonet Adapters allow thermocouple placement without drilling and tapping of holes to attach the adapters. The bayonet adapter sits external to the pipe. This is ideal for smaller diameter pipe temperature measurement.

PIPE CLAMP BAYONET ADAPTER DIMENSIONS

CLAMPING RANGE

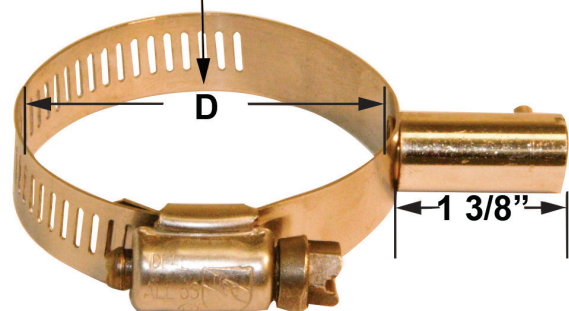

PIPE CLAMP BAYONET ADAPTER - ORDER CODE

BA - PIP - D

THREAD x PITCH

- M12x1.0 - M12 THREAD/ 1.0mmPITCH
- M12x1.5 - M12 THREAD/ 1.5mmPITCH
- M12x1.75 - M12 THREAD/ 1.75mmPITCH
- M14x1.5 - M14 THREAD/ 1.5mmPITCH